

NACHI BLFL6J Bearing unit

Bearing No. BLFL6J

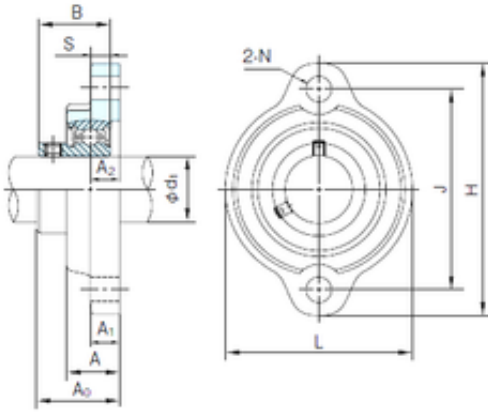

BLFL6J Bearing 2D drawings and 3D CAD models

Bore Diameter	30 mm
d	30 mm
A0	34.3 mm
A	22.5 mm
A1	12 mm
B	30.3 mm
H	113 mm
J	90.5 mm
L	79 mm
N	12 mm
S	8 mm
Bolt (G)	M10
A2	12 mm